

Jabra®

JABRA ECLIPSE

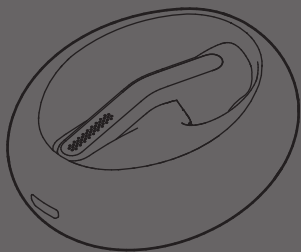

User Manual

jabra.com/eclipse

A BRAND BY

GN Netcom

© 2015 GN Netcom A/S. All rights reserved. Jabra® is a registered trademark of GN Netcom A/S. All other trademarks included herein are the property of their respective owners. The Bluetooth® word mark and logos are owned by the Bluetooth SIG, Inc. and any use of such marks by GN Netcom A/S is under license. (Design and specifications subject to change without notice).

MADE IN CHINA
MODEL: OTE25



Declaration of Conformity can be found on www.jabra.com/CP/US/declarations-of-conformity

1. WELCOME	5
2. PRODUCT OVERVIEW	6
2.1 INCLUDED ACCESSORIES	
3. HOW TO WEAR.....	8
3.1 SELECTING THE CORRECT EARGELS	
3.2 GETTING THE CORRECT FIT	
4. HOW TO CHARGE	10
4.1 ON-THE-GO CHARGING	
4.2 USB CHARGING	
5. HOW TO CONNECT	14
5.1 TURNING THE HEADSET ON/OFF	
5.2 CONNECT USING THE APP	
5.3 CONNECT VIA BLUETOOTH	
5.4 CONNECT WITH AN NFC-ENABLED DEVICE	
6. JABRA ASSIST APP	17
7. HOW TO USE	18
7.1 CALLS	
7.2 HEADSET VOICE CONTROLS	
7.3 HEADSET VOICE GUIDANCE	
7.4 PHONE VOICE COMMANDS (SIRI, GOOGLE NOW, CORTANA)	
7.5 CALLER ID	

7.6	MULTIPLE CALL HANDLING	
7.7	HOW TO CHANGE HEADSET LANGUAGE	
7.8	HOW TO UPDATE HEADSET FIRMWARE	
7.9	HOW TO RESET THE HEADSET	
8.	SUPPORT	25
8.1	FAQ	
8.2	HOW TO CARE FOR YOUR HEADSET	
9.	TECHNICAL SPECIFICATIONS	26

1. WELCOME

Thank you for using the Jabra Eclipse. We hope you will enjoy it!

JABRA ECLIPSE FEATURES

- Button-free headset - gently tap/double tap the headset*
- Up to 10 hours talk time (up to 3 hours in the headset and up to 7 hours in the charging case)**
- Power Nap for extended standby time
- Dual microphones for noise cancellation
- Connect with NFC**
- HD voice compatible**
- Headset voice guidance***
- Headset voice control***
- Phone voice commands - supports Siri/Google Now/Cortana**
- Wireless freedom - Up to 30 meters/98 feet**
- Portable charging case included
- Comfortable EarGels in various sizes (XS, S, M and L) included

*Tapping the headset too hard may create a sound that could damage your hearing

**Phone/network dependent

*** 11 language options available if using the Jabra Assist app

2. PRODUCT OVERVIEW

HEADSET

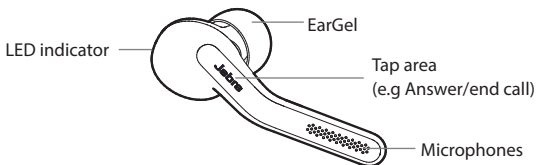

CHARGING CASE (TOP VIEW)

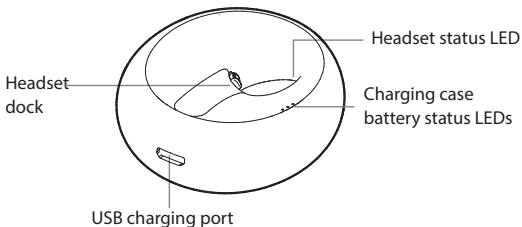

CHARGING CASE (BOTTOM VIEW)

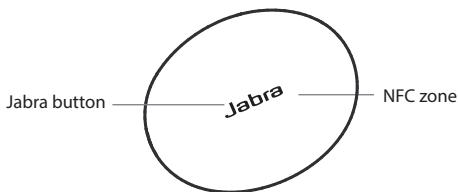

2.1 INCLUDED ACCESSORIES



USB cable



Large
EarGel



Medium
EarGel



Small
EarGel



Extra-
small
EarGel

NOTE: You can purchase an additional charging case and accessories online at jabra.com

3. HOW TO WEAR

The headset is designed for right ear wearing. For the optimal sound quality and the most comfortable fit, select the correct EarGel size and ensure the headset is fitted correctly into your ear.

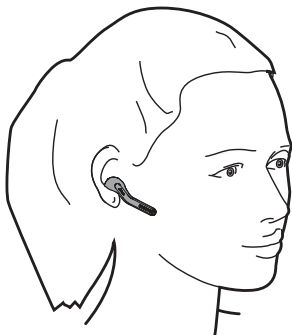

3.1 SELECTING THE CORRECT EARGELS

The headset is supplied with four EarGel sizes: large, medium, small and extra small. The correct EarGel will feel tight and seal out background disturbances.

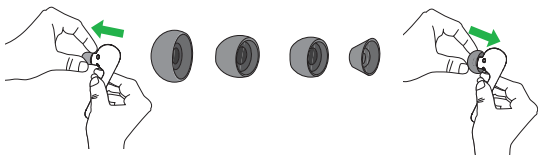

3.2 GETTING THE CORRECT FIT

Fit the headset firmly inside your right ear, and angle the microphone down towards your mouth.

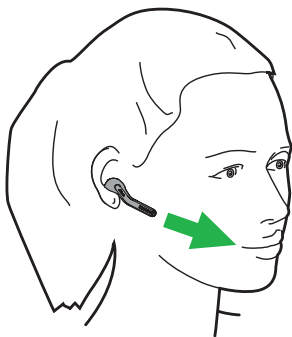
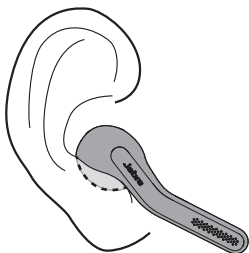

4. HOW TO CHARGE

It is recommended to fully charge the headset and the charging case before first-time use.

Fully charged the headset will have up to 3 hours of talk time, and the charging case will have up to 7 hours of battery.

4.1 ON-THE-GO CHARGING

Dock the headset in the charging case for on-the-go charging. It takes approx. 2 hours to fully charge the headset.

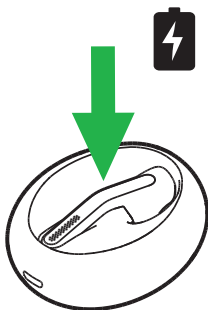

4.2 USB CHARGING

Plug the charging case into a USB power supply using the supplied USB cable to charge the headset and/or the charging case. It takes approx. 3 hours to charge the headset and the charging case together.

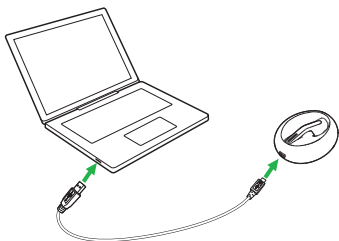

4.3 BATTERY STATUS

To hear the current remaining talk time in your headset, gently tap the headset when it is in your ear and you are not on a call.

To see the charging case battery status and/or the headset battery status (when docked), tap the Jabra button on the bottom of the charging case.

HEADSET BATTERY STATUS

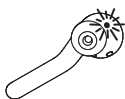

20-100% battery



0-20% battery

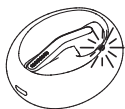

20-100% battery



0-20% battery

CHARGING CASE BATTERY STATUS



66-100% battery



33-66% battery



0-33% battery

4.4 POWER NAP

To extend standby time the headset will automatically enter Power Nap mode when the headset is out of range of your connected mobile device for more than 15 minutes, or when the headset has not been moved for 1 hour. Power Nap provides up to 7 days of battery readiness/standby time.

To exit Power Nap simply move the headset. Your mobile device must be switched on, within range, and have Bluetooth enabled.

To answer an incoming call when the headset is in Power Nap mode, simply wear the headset and double-tap it to answer the call.

5. HOW TO CONNECT

5.1 TURNING THE HEADSET ON/OFF

ON: Undock the headset from the charging case.

OFF: Dock the headset in the charging case. The Headset status LED will briefly light up white when the headset is docked.

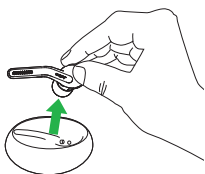

ON

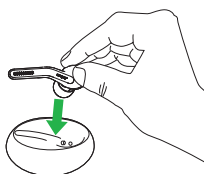

OFF

5.2 CONNECT USING THE APP

The easiest way to connect to your mobile device is to download and use the Jabra Assist app for iOS or Android devices.



5.3 CONNECT VIA BLUETOOTH

1. Dock the headset in the charging case, and ensure the headset is charged.
2. Press and hold (3 secs) the **Jabra** button on the bottom of the charging case until the light flashes blue.

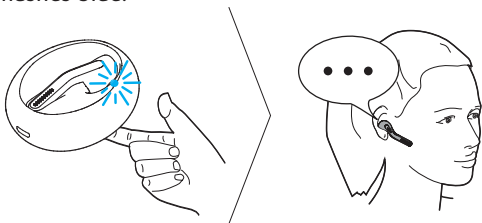

3. Wear the headset and follow the voice-guided instructions.

NOTE: Connecting via Bluetooth only needs to be completed the first time you are connecting to a new device.

5.4 CONNECT WITH AN NFC-ENABLED DEVICE

Dock the headset in the charging case, and slide your NFC-enabled device against the NFC zone on the bottom of the charging case until a connection is confirmed on your mobile device.

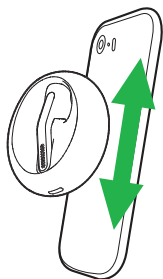

6. JABRA ASSIST APP

The Jabra Assist app is a free app for iOS or Android devices that enables you to:

- Customize your in-call audio
- Change headset language
- Automatic text message read-out
- Update headset firmware
- Enable/disable headset voice guidance
- And more..



Jabra Assist

Android download - Google Play
iOS download - App Store

7. HOW TO USE

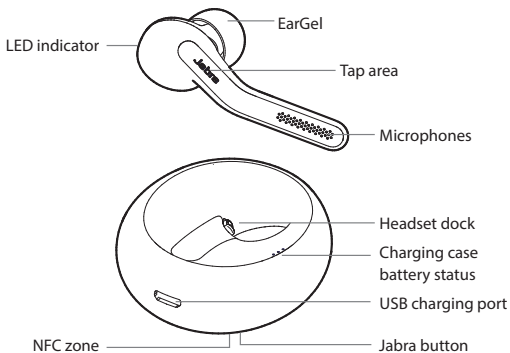

7.1 CALLS

USING THE CHARGING CASE



Turn on headset

Undock the headset from the charging case

Turn off headset

Dock the headset in the charging case

Answer call

Undock the headset from the charging case

End/reject call

Dock the headset in the charging case

HEADSET IN EAR

Answer call Gently double-tap the headset, or say 'Answer'

End call Gently double-tap the headset



Reject call Say 'Ignore'

Activate Siri/
Google Now/
Cortana
(phone
dependent) Gently double-tap the headset
when not on a call

Headset
battery status Gently tap the headset when not
on a call

7.2 HEADSET VOICE CONTROLS

Headset voice controls are commands you can speak to control the headset.

WHAT YOU CAN SAY	WHAT IT MEANS
Answer	Answer incoming call
Ignore	Reject incoming call

Voice controls are available in the following languages: English (US), Chinese (Mandarin), Japanese, French, German, Russian, Polish, Dutch, Spanish, and Italian.

Language packs can be downloaded using the Jabra Assist app. If the headset language is changed, please refer to that language's user manual for the correct voice controls.

7.3 HEADSET VOICE GUIDANCE

Headset voice guidance are voice announcements intended to guide you or give headset status updates (e.g. connection and battery status).

Voice guidance is available in the following languages: English (US), Chinese (Mandarin), Japanese, French, German, Russian, Polish, Dutch, Spanish, Italian and Farsi.

Language packs can be downloaded using the Jabra Assist app.

7.4 PHONE VOICE COMMANDS (SIRI, GOOGLE NOW, CORTANA)

Phone voice commands enable you to speak to Siri/Cortana/Google Now on your mobile phone using your headset. For more information on using Siri, Google Now, or Cortana, please refer to your phone's user manual.



Activate Siri/Google Now/Cortana (phone dependent)

Gently double-tap the headset when not on a call

7.5 CALLER ID

Caller ID is the voice announcement of a contact name when there is an incoming call.

The following requirements for Caller ID must be met:

- The mobile phone must support the Bluetooth Phone Book Access Profile (PBAP)
- The incoming call's phone number must be associated with a stored contact in the phone
- The incoming call must not be from an unknown, unlisted, or blocked caller

NOTE: Japanese Caller ID supports phone number readout only. Chinese Caller ID supports Chinese Simplified only.

7.6 MULTIPLE CALL HANDLING

The headset can answer or reject calls when you are already on a call.

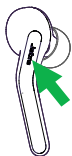

End current call and answer incoming call

Gently double-tap the headset

Reject incoming call, when on a call

Gently tap the headset

7.7 HOW TO CHANGE HEADSET LANGUAGE

The headset language can be changed using the Jabra Assist app.

The headset language can be changed to one of the following languages: English (US), Chinese (Mandarin), Japanese, French, German, Russian, Polish, Dutch, Spanish, Italian, and Farsi.

7.8 HOW TO UPDATE HEADSET FIRMWARE

To update headset firmware to the latest version, download and use the Jabra Assist app for iOS or Android, or go to jabra.com/eclipse for more help.

7.9 HOW TO RESET THE HEADSET

Resetting the headset will clear the list of connected devices. You will need to reconnect to your mobile device/s.

1. Dock the headset in the charging case, and connect the charging case to power using the USB cable.
2. Press and hold (8 secs) the **Jabra** button on the bottom of the charging case until the light flashes purple rapidly. Release the button.

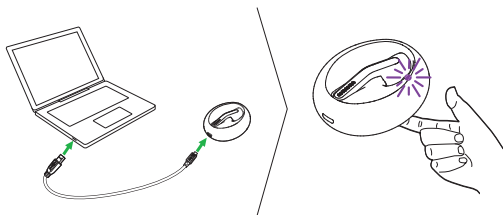

8. SUPPORT

8.1 FAQ

View the FAQs on jabra.com/eclipse

8.2 HOW TO CARE FOR YOUR HEADSET

- Always store the headset with the power off and safely protected.
- Avoid storage at extreme temperatures (above 70°C/158°F or below -20°C/-4°F). This can shorten battery life and may affect the headset.

9. TECHNICAL SPECIFICATIONS

JABRA ECLIPSE	SPECIFICATION
Weight:	Headset 5.5 g (0.19 oz) Charging case 35 g (1.23 oz)
Dimensions:	Headset L 49.95 mm x W 17.58 mm x H 24.82 mm Charging case L 62.2 mm x W 54 mm x H 25.5 mm
Microphones:	2 x Omnidirectional MEMS microphones
Microphone frequency range:	100 Hz - 8 kHz
Microphone sensitivity:	14 dB +/- 3 dB (SWR)
Speaker type:	6 mm dynamic speaker
Speaker sensitivity:	94 dB SPL at 1 mW /1 kHz
Speaker impedance:	16 ohm
Speaker max input power:	5 mW
Speaker frequency range:	20 Hz - 20 kHz
Operating range:	Up to 30 m/98 ft (phone dependent)

JABRA ECLIPSE	SPECIFICATION
Bluetooth version:	4.1
Paired devices:	Up to 8, connected to two at the same time (MultiUse™)
Supported Bluetooth profiles:	Headset profile (v1.2), hands free profile (v1.6), A2DP (v1.3), phone book access profile (v1.0)
Talk/battery time:	Up to 10 hours (up to 3 hours in headset, and up to 7 hours in charging case)
Standby time:	Up to 3 days
Power Nap time:	Up to 7 days
Charging time:	Approx. 2 hours for headset only. Approx. 3 hours for headset and charging case together
USB charging cable:	5 V, >100 mA
Operating temperature:	-10°C to 55°C (14°F to 131°F)
Storage temperature:	-20°C to 70°C (-4°F to 158°F)
Pairing passkey or PIN:	0000
	Eargel: Thermoplastic Elastomer (TPE), Silicon Rubber.
Product materials:	Headset and charging case: Polycarbonate/Acryl Butadien Styren (PC/ABS), Polycarbonate (PC), Silicon Rubber

